



UGC SERIES

ALUMINUM GANTRY CRANE

CAPACITY UP TO 2,200 LBS

The adjustable enclosed track aluminum gantry crane is a perfect solution anywhere lifting equipment is required on an infrequent basis. Large locking casters allow the gantry to be moved with ease & out the way when not in use.

BENEFITS & FEATURES

ADJUSTABILITY

Adjustable in 6" lifting heights

LOAD SAFETY

Locking heavy-duty casters

EASE OF MOVEMENT

Profile is extruded from high grade 6005-T5 aluminum.

Enclosed track design allows for low rolling resistance on beam.

OTHER FEATURES

Designed to make installation easy. Inspection gate installed (standard) for quick trolley removal.

Powder-coat option available.





ALUMINUM GANTRY CRANE

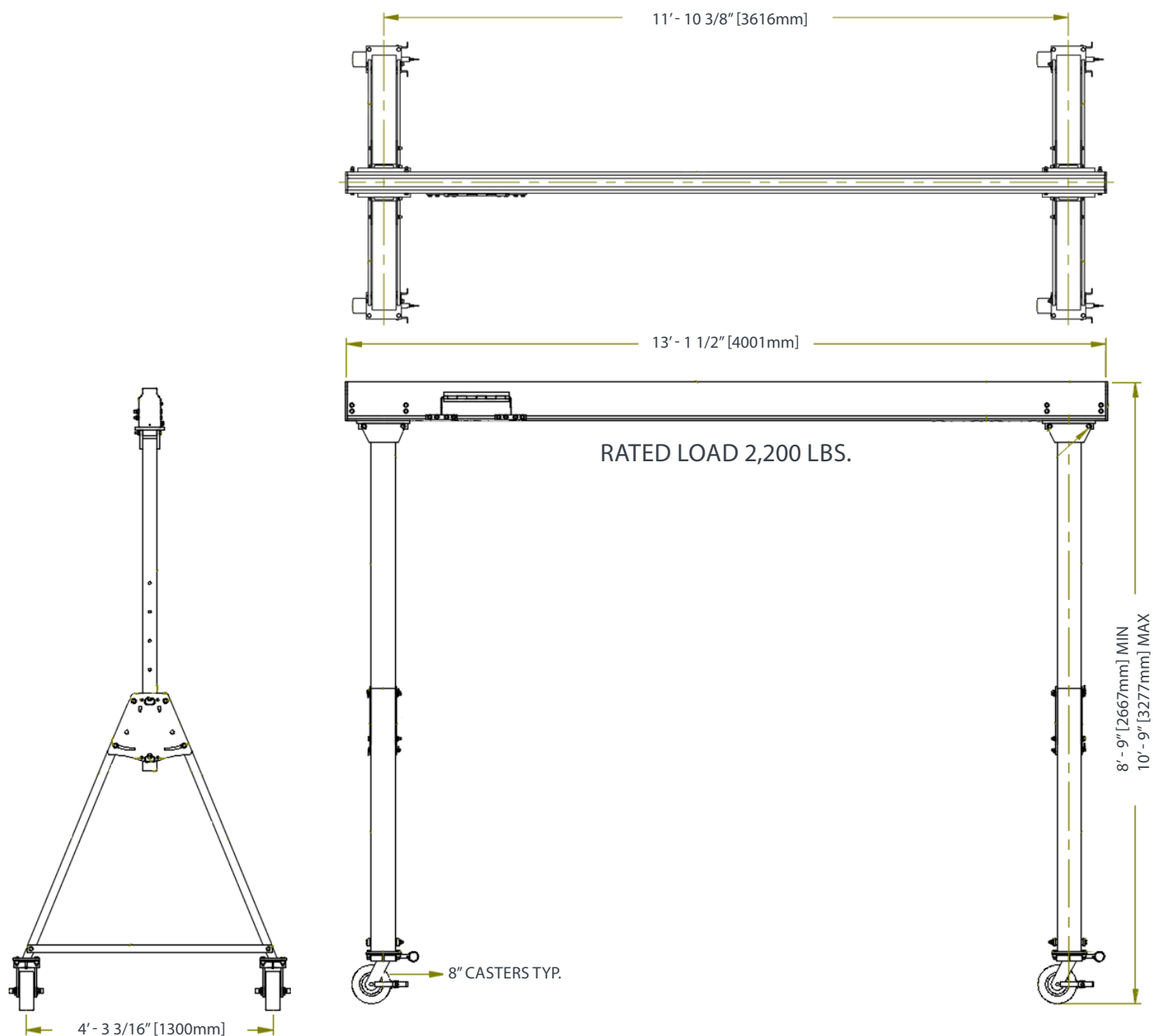

Consult factory for other sizes and capacities.



UNIFIED INDUSTRIES, INC.
A Columbus McKinnon Company

Phone: 517.546.3220 · Fax: 517-546-0696
www.unified-ind.com